

French Doors Sound Proof Measuring Form

Name: _____

Address _____

Phone (day): _____ (evening): _____

FAX and VOICE contact: Toll-free 866-547-5376

<http://www.soundproofanyroom.com>

energy123@comcast.net

Door # _____

Door location: _____

Measurements:

Width | 1 - _____ Height | 3 - _____
 | 2 - _____ | 4 - _____

Space between doorknob rosette and window frame | 5 - _____

The Color You Want:

White Dark brown Other _____

Door # _____

Door location: _____

Measurements:

Width | 1 - _____ Height | 3 - _____
 | 2 - _____ | 4 - _____

Space between doorknob rosette and window frame | 5 - _____

The Color You Want:

White Dark brown Other _____

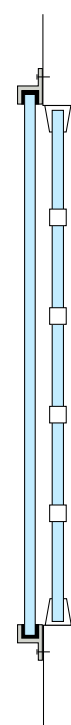
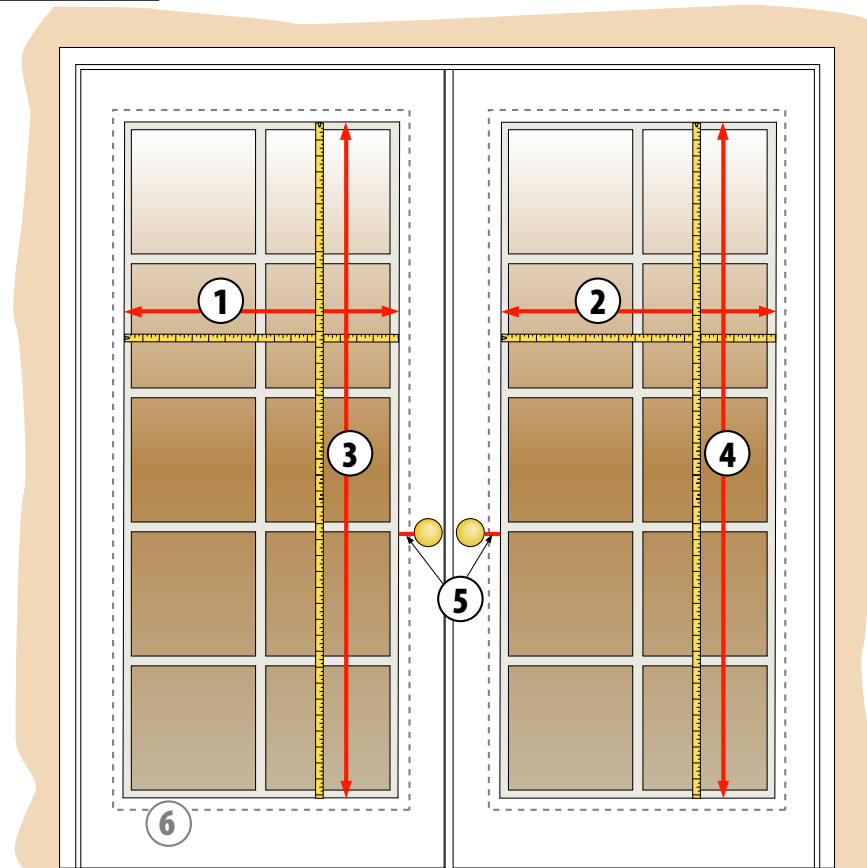

Sound Proof French Door cross-section side view.

- ① and ② Measure full width of each window section. End to end, side to side.
- ③ and ④ Measure full height of each window section. End to end, top to bottom.
- ⑤ Measure distance between doorknob rosette and wood trim of existing windows.
- ⑥ Dotted line indicates 1.25-inch frame for Insulated Door Treatment.